



RESIDENTIAL SALES & LETTING AGENTS

✉ sales@mkiea.co.uk 🌐 www.mkiea.co.uk ☎ 0161 428 3663

25 The Spinney, Cheadle, SK8 1JA

Offers Over £1,300,000

5 3 4



Welcome to one of Cheadle's most exceptional homes, a stunning contemporary residence boasting over 4,000 square foot of luxurious living space. Situated on one of the area's most prestigious roads, this home is set on a large, beautifully landscaped plot surrounded by mature trees and greenery, offering a tranquil retreat just a short stroll from the vibrant heart of Cheadle village. With its array of shops, café bars, and restaurants, as well as the expansive Bruntwood Park right on your doorstep, this property enjoys an enviable location.

Thoughtfully designed for modern family living, this home blends open-plan spaces with cosy, private areas. The ground floor is entered via a striking reception hall bathed in natural light, leading into the central hub of the home—a magnificent open plan living space with a bespoke fitted kitchen and expansive views over the rear garden. Complementing this are a separate dining room, two versatile reception rooms, a utility room, a ground floor WC, and a boiler room.

The first floor continues to impress, with a spacious landing leading to the main bedroom suite. This luxurious retreat includes a dressing area, a stunning bath/shower room, and a private rear balcony—perfect for enjoying your morning coffee amidst delightful surroundings. Four further generously sized double bedrooms are located on this floor, three of which enjoy access to a stunning roof garden. Two additional luxury bathrooms complete the first floor accommodation.

This home is equipped with gas central heating and double glazing throughout, ensuring comfort and efficiency. Externally, the property features a secure gated frontage with ample parking for several vehicles, an integral double garage offering potential for conversion if desired, and a breath taking, private rear garden. With its expansive lawn, mature borders, and a variety of seating areas, this outdoor space is perfect for both relaxation and entertaining. This extraordinary home offers an unrivalled combination of style, space, and location - truly one of Cheadle's finest residences.



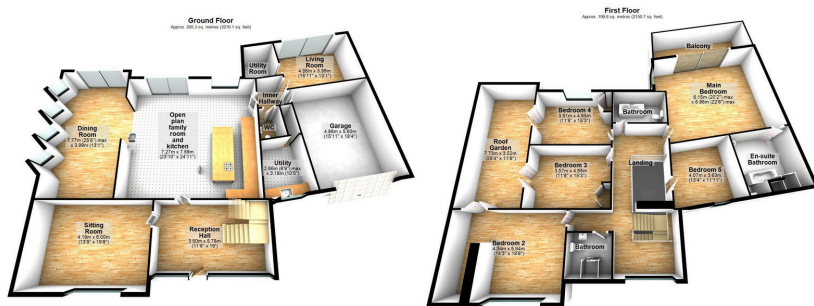

Total area approx. 455.1 sq. metres (4360.8 sq. feet)

- Over 4,000 sq ft of contemporary design
- Large, private plot surrounded by greenery
- Stunning reception hall with abundant natural light
- Five double bedrooms, including luxurious main suite
- Secure gated frontage, ample parking, and double garage
- Prestigious location on one of Cheadle's premier roads
- Short stroll to Cheadle village and Bruntwood Park
- Magnificent open-plan living space with kitchen/garden views
- Beautiful roof garden accessible from bedrooms
- Immaculate lawned rear garden with multiple seating areas

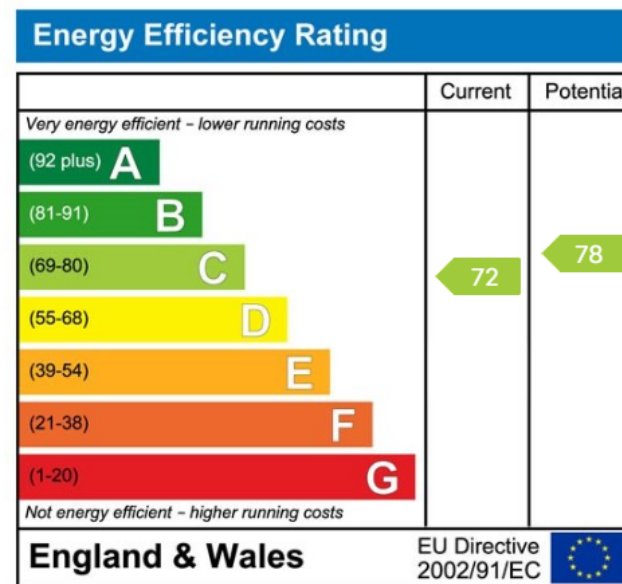

Your home may be repossessed if you do not keep up repayments on your mortgage N.B. Maurice Kilbride Residential Sales and Lettings Limited for themselves and for the vendors or lessors of this property whose agents they are given notice that; 1. The particulars are set out as a general outline only for the guidance of intending purchasers or lesser and do not constitute part of an offer or contract. 2. All descriptions, dimensions, references and condition or necessary permission for use and occupation and other details are given without responsibility or intending purchasers or tenants should not rely on them as statement or representations of face must satisfy themselves in inspection or otherwise as to the correctness of each of them. 3. No person in the employment of Maurice Kilbride Residential Sales or Lettings Limited has any authority to make or give any representation or warranty whatever in relation to this property.