



## RESIDENTIAL SALES & LETTING AGENTS

✉ [sales@mkiea.co.uk](mailto:sales@mkiea.co.uk) 🌐 [www.mkiea.co.uk](http://www.mkiea.co.uk) ☎ 0161 428 3663



Woodstock Avenue, Cheadle Hulme, SK8 7LD

Offers Over £390,000

3 1 2





Quietly situated in the ever-popular Cheadle Hulme, this deceptively spacious mid-terrace home is a true hidden gem. Behind its façade lies a beautifully presented and thoughtfully extended property, designed with modern family living in mind. Step inside, and you're greeted by a welcoming entrance hall with a handy cloakroom/WC. The stylish open plan lounge flows effortlessly into a versatile dining/family area—which provides numerous options.

The real showstopper, however, is the stunning extended kitchen/breakfast room. Boasting sleek contemporary units, luxury integrated appliances, and gorgeous bi-fold doors opening onto the garden, it's a delightful, light and airy space to enjoy cooking or just a morning coffee. Upstairs, three well proportioned bedrooms are complemented by a contemporary shower room/WC combined.

Practicality meets comfort with gas central heating, double glazing, and lots of storage throughout. Outside, the front driveway offers parking for two cars, while the generous rear garden is an ideal family retreat. Adding a touch of versatility, a large detached outbuilding—perfect as a home office, gym, or man cave, enhances the appeal.

Positioned literally round the corner from Thorn Grove Primary School, this home is perfectly placed for families. Cheadle Hulme itself is one of Greater Manchester's most sought-after locations, boasting a fantastic array of independent shops, Waitrose, stylish café bars, restaurants, and excellent transport links—including its own train station. With top rated schools on the doorstep, this is a rare opportunity to secure a superb home in a prime location. Don't miss out, book a viewing today.



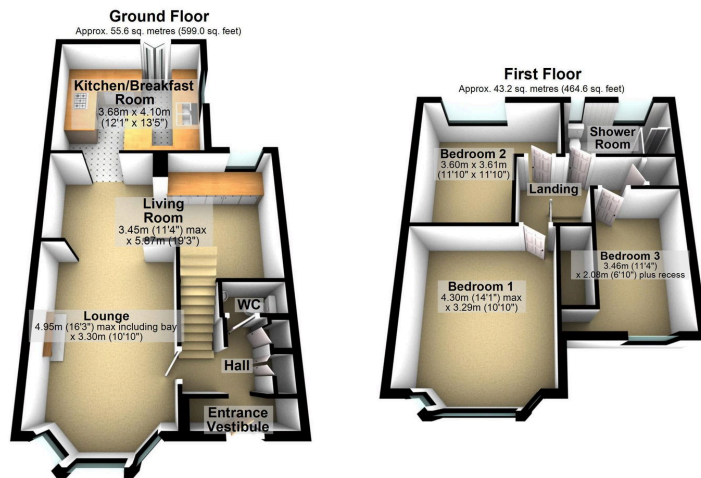

Total area: approx. 98.8 sq. metres (1063.6 sq. feet)

- Spacious mid terrace in sought after Cheadle Hulme.
- Stunning extended kitchen with bi-fold doors.
- Open plan lounge & dining/ family room.
- Three good sized bedrooms & luxury shower room.
- Gas central heating & double glazing.
- Large outbuilding - ideal office, gym, or man cave.
- Generous rear garden for relaxing & entertaining.
- Driveway parking for two cars.
- Close to top rated schools.
- Popular location convenient to shops, cafés & train.

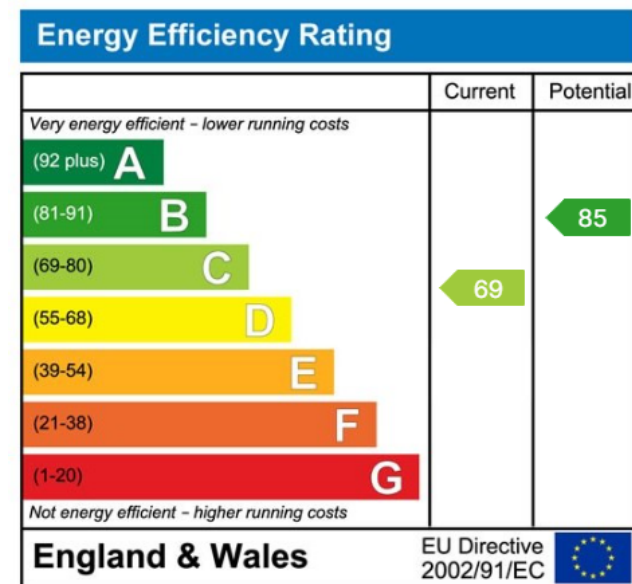

Your home may be repossessed if you do not keep up repayments on your mortgage N.B. Maurice Kilbride Residential Sales and Lettings Limited for themselves and for the vendors or lessors of this property whose agents they are given notice that; 1. The particulars are set out as a general outline only for the guidance of intending purchasers or lesser and do not constitute part of an offer or contract. 2. All descriptions, dimensions, references and condition or necessary permission for use and occupation and other details are given without responsibility or intending purchasers or tenants should not rely on them as statement or representations of face must satisfy themselves in inspection or otherwise as to the correctness of each of them. 3. No person in the employment of Maurice Kilbride Residential Sales or Lettings Limited has any authority to make or give any representation or warranty whatever in relation to this property.