

## 11 Bosley Road, Cheadle Heath, SK3 0NQ

Offers Over £110,000

🛏 1 🚿 1 🚗 1



A realistically priced ground floor flat in an established and convenient location – ideal for first time buyers or buy to let investors! Located within easy reach of Stockport town centre, train station, local shops and motorway links, this one bedroom flat offers an affordable entry point into the market. The property has been freshly decorated and features a newly installed kitchen and shower room, a good sized living room, and one decent bedroom. Additional benefits include double glazing, a small enclosed lawned rear garden, and off road parking to the front. While there's still scope to make it your own, this is a great opportunity to secure a flat offered with no onward chain – early viewing recommended!

## Key Features

- Ground floor one bed flat
- Freshly decorated throughout
- New shower room installed
- Parking space at the front
- Approx. 8.2% yield – ideal for landlords
- Convenient for Stockport town centre & train station
- New fitted kitchen
- Small lawned garden – rare at this price point
- Just £110,000 purchase price!
- No chain – move in or let out straight away!

## Ground Floor

Approx. 39.8 sq. metres (428.4 sq. feet)

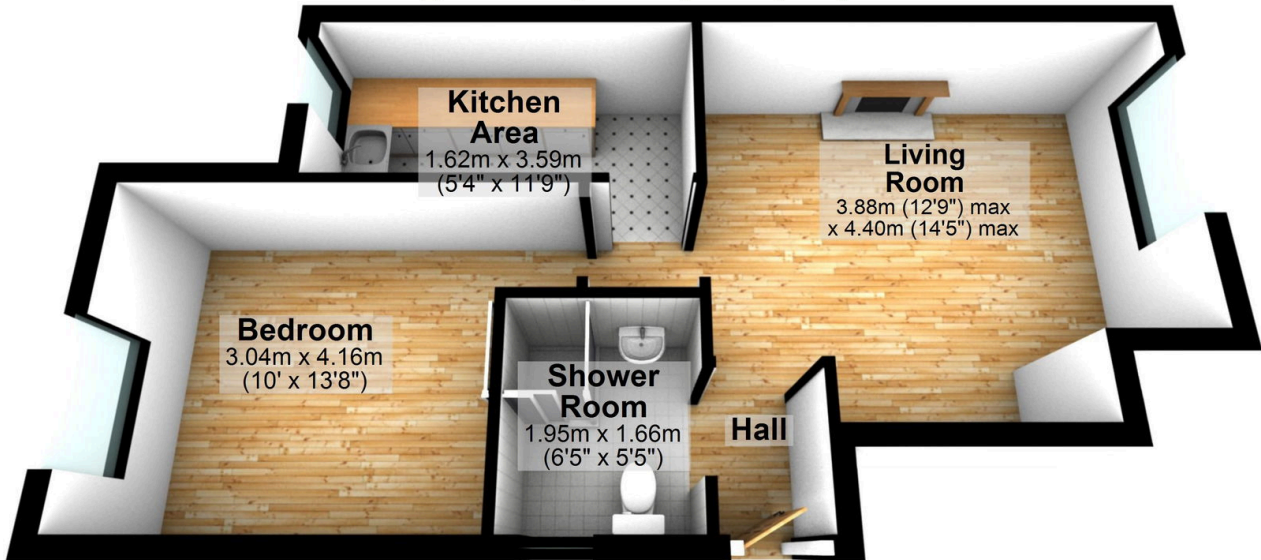

Total area: approx. 39.8 sq. metres (428.4 sq. feet)