

Apartment 24, 10 Eden Place, Cheadle, SK8 1DJ

£225,000

 2  1  1



Step into stylish village living at Eden Place, a recently converted development in the very heart of Cheadle. This nicely presented top floor apartment is the perfect choice for first-time buyers or those looking to downsize without compromising on style or convenience. The contemporary open plan layout features a light filled reception area flowing into a well fitted kitchen with premium integrated appliances, ideal for entertaining or relaxed evenings. There are two bedrooms, plus a stylish bathroom/WC combined. Practicality hasn't been overlooked, with lift access, secure gated entry, and your own allocated parking space to the rear. Just outside your door lies the buzz of Cheadle village with its independent shops, cafés, restaurants and excellent transport links, putting modern village life truly within reach. Offered with no vendor chain.

Key Features

- Stylish top floor apartment conversion.
- Prime Cheadle village location – shops, cafés & restaurants on your doorstep
- Spacious open plan living/dining & kitchen
- Integrated appliances including fridge/freezer & oven
- Two bedrooms, one with fitted wardrobes
- Contemporary bathroom /WC combined
- Lift access to all floors for convenience
- Secure gated entry with code access
- Allocated private parking space & visitor spaces
- Offered with no vendor chain – move straight in

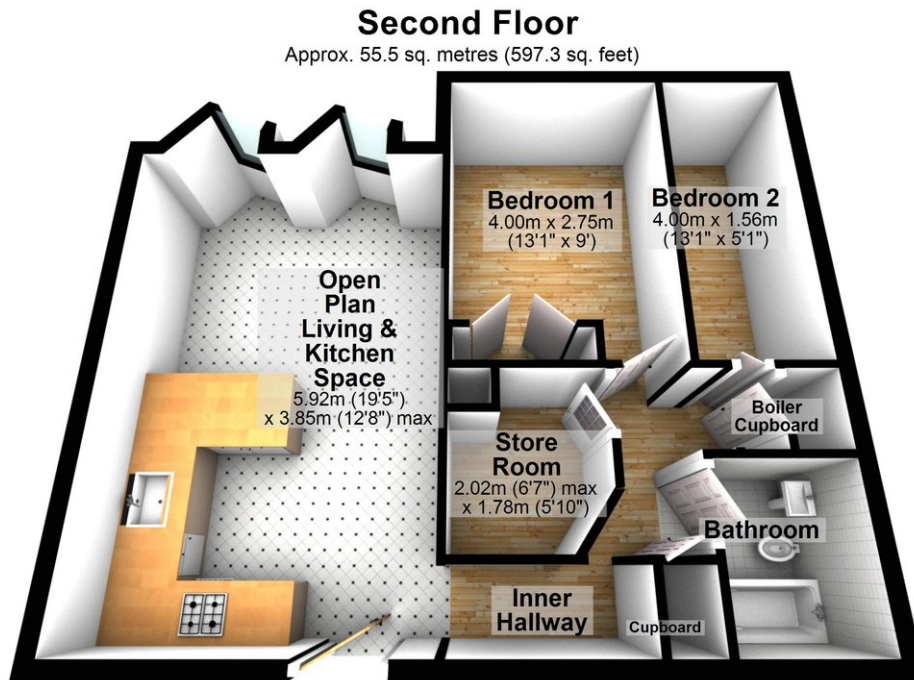

Total area: approx. 55.5 sq. metres (597.3 sq. feet)