

## 32 Twining Brook Road, Cheadle Hulme, SK8 5PU

Offers Over £300,000

 2  1  1



Tucked away on the ever popular Twining Brook Estate in Cheadle Hulme, this beautifully presented two bedroom bungalow offers the perfect blend of comfort, convenience and low maintenance living, ideal for downsizers seeking a simpler lifestyle without compromise. Positioned on a generous corner plot, the property enjoys a bright and spacious living room with patio doors opening into a light filled conservatory, creating a seamless space to relax or entertain. A well fitted kitchen, two bedrooms, and a stylish modern shower room complete the internal accommodation. Externally, the low maintenance rear garden provides a private and manageable outdoor space, while off road parking and a garage add further practicality. Offered for sale with no onward chain, this is a home ready to move straight into and enjoy from day one.

## Key Features

- Sought after Twining Brook Estate location
- Ideal for downsizers, couples or single occupants
- Well presented and ready to move into
- Spacious living room with garden facing aspect
- Light filled conservatory for year round enjoyment
- Modern kitchen with excellent storage
- Two well-proportioned bedrooms
- Stylish, low maintenance shower room
- Private, easy-to-manage rear garden
- Off road parking, garage & no onward chain

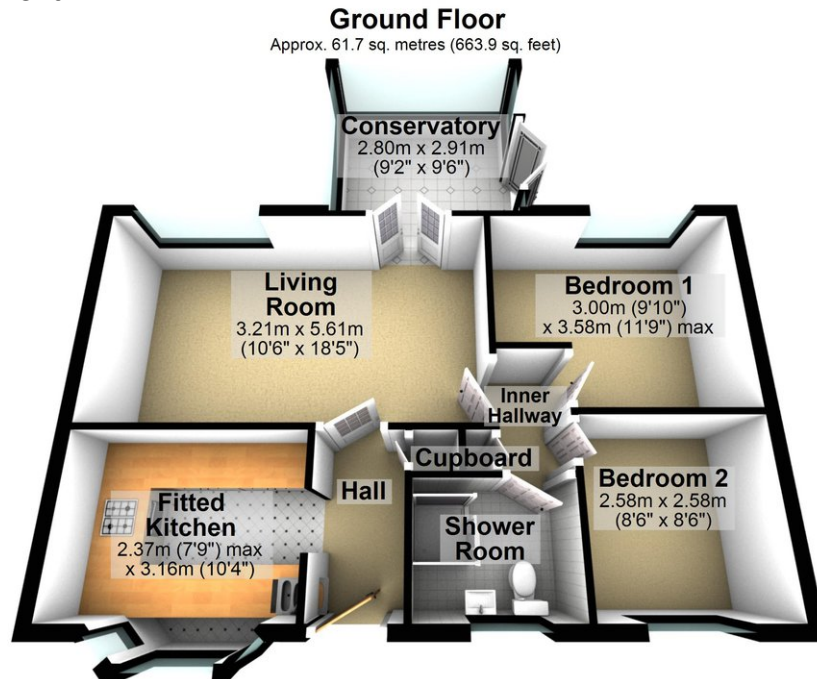

Total area: approx. 61.7 sq. metres (663.9 sq. feet)