



RESIDENTIAL SALES & LETTING AGENTS

✉ sales@mkiea.co.uk 🌐 www.mkiea.co.uk ☎ 0161 428 3663

Foxland Road, Gatley, SK8 4QB

Offers Over £600,000

5 3 2



Stylishly presented throughout and offering almost 1,600 square feet of exceptionally versatile accommodation, this impressive detached family home occupies a generous plot in one of Gatley's most sought after residential locations, just a short stroll from the village centre, train station, highly regarded schools and with excellent access to Manchester Airport and the national motorway network.

Designed with modern family living in mind, the accommodation briefly comprises of an entrance hall, rear living room, separate family/sitting room offering excellent flexibility as a children's playroom, dining room second lounge, together with a contemporary fitted kitchen/breakfast room providing an ideal space for both everyday family life and entertaining. A modern ground floor shower room adds further practicality for busy households and visiting guests.

To the first floor are five well proportioned bedrooms, including a principal bedroom complete with an en-suite shower room, together with a well appointed family bathroom finished to an excellent specification.

Outside, the property continues to impress, occupying a generous mature plot with attractive gardens to the front, side and rear. The enclosed rear garden is mainly laid to lawn and bordered by an abundance of mature trees, shrubs and established planting, creating a high degree of privacy together with plenty of space for children to play, family gatherings and outdoor entertaining. To the front, a driveway provides ample off-road parking and leads to the integral garage, which offers excellent storage or exciting potential for conversion into additional living accommodation should a future purchaser require even more space (subject to the necessary consents). Likewise, the generous plot presents further opportunities to extend if desired, making this a home that can continue to evolve as your family's needs change.

Offering immediate move in quality, generous living space and genuine scope for future development, this is a rare opportunity to secure a beautifully presented family home that offers not only everything you need today, but the flexibility to grow with you tomorrow.



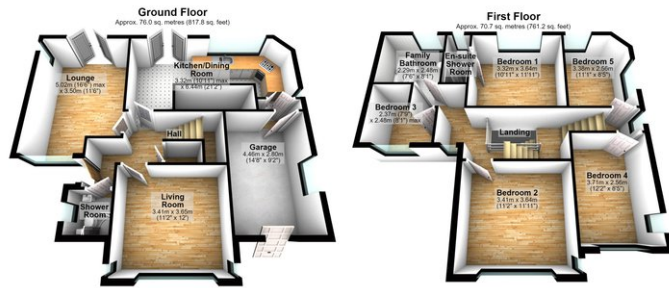

Total area: approx. 146.7 sq. metres (1579.0 sq. feet)

- Stylish detached family home extending to almost 1,600 sq ft
- Five well proportioned bedrooms
- Two versatile reception rooms ideal for family living
- Main bedroom with en-suite shower room
- Two further bathrooms
- Contemporary fitted kitchen/breakfast room
- Generous mature gardens to the front, side and rear
- Driveway parking plus integral garage
- Excellent potential to convert the garage or extend further (STPP)
- Walking distance to Gatley Village, train station and excellent commuter links



Your home may be repossessed if you do not keep up repayments on your mortgage N.B. Maurice Kilbride Residential Sales and Lettings Limited for themselves and for the vendors or lessors of this property whose agents they are given notice that; 1. The particulars are set out as a general outline only for the guidance of intending purchasers or lesser and do not constitute part of an offer or contract. 2. All descriptions, dimensions, references and condition or necessary permission for use and occupation and other details are given without responsibility or intending purchasers or tenants should not rely on them as statement or representations of face must satisfy themselves in inspection or otherwise as to the correctness of each of them. 3. No person in the employment of Maurice Kilbride Residential Sales or Lettings Limited has any authority to make or give any representation or warranty whatever in relation to this property.