

199 Old Chapel Street, Edgeley, SK8 9LR

Offers Over £210,000

🛏 3 🚿 1 🚗 1



Are you looking for your first home? or potentially a property to add to your buy to let portfolio if you are a landlord? Take a look at this semi detached home, which is situated in a popular location, close to local shops, Stockport station and town centre. The property, which is need of some cosmetic updating, offers generous accommodation including an open plan living/dining room, modern fitted kitchen, useful basement storage cellar, two bedrooms and an office or three bedrooms depending on your personal requirements and a shower room/WC combined. Other features include gas central heating and double glazing. Externally, there is an enclosed, private rear garden and on street parking at the front.

Key Features

- Three bedroom semi detached house
- Open plan living/dining room
- Shower room/WC combined
- Gas central heating and double glazing
- Some cosmetic updating required
- Popular location close to Stockport train station and town centre
- Modern fitted kitchen
- Useful basement storage cellar
- Private rear garden
- Superb value starter home or buy to let investment opportunity

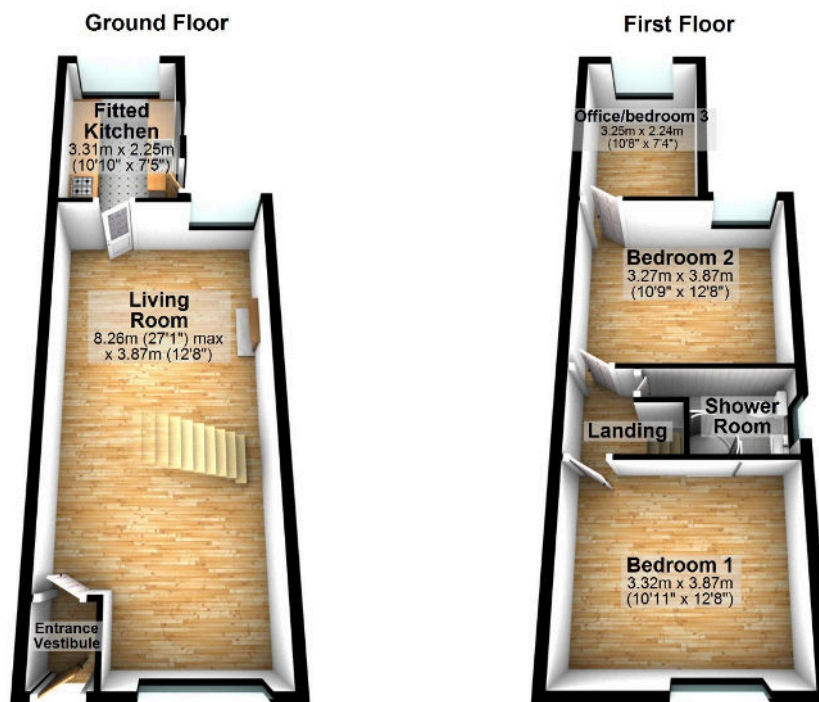

Total area: approx. 79.0 sq. metres (850.2 sq. feet)